

Realized Stable High-Speed Machining & Environmental Performance Together

Broach Transfer Type, Mechanical-Vertical 50kN Broaching Machine

NBV-MA series

The NBV-MA-series is a mechanical-vertical broaching machine which has been developed based on the hydraulic type NBV-series with high reliability. The running cost has been reduced without hydraulic devices, and the environmental performance has been improved. The efficient productivity has been realized with high-versatile pulling force.

High-Speed & Stable Machining by Servo-Motor

- 2.3x Machining Speed
(6m/min → 15m/min, Ram ADV-RET time reduced: 14sec. → 6sec.)
- Cutting Vibration Reduced with Ball Screw

Simple & Easy Change-over

- It is able to set the broach length (range: 300mm) and the ram stroke just on the touch panel easily because the broach lifter and the ram are driven by servo motors.

Clean•Energy Saving•Space Saving

- Easy Maintenance by Reducing M/C Components
- 40%-Reduced Space Compared to NACHI's Conventional M/C's
- Clean Operativity without Hydraulic Devices, Lower Running Costs



Comparison with NACHI's Conventional Products:

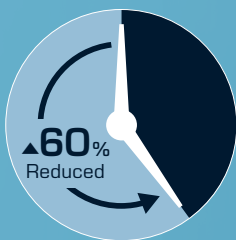

Broaching Time

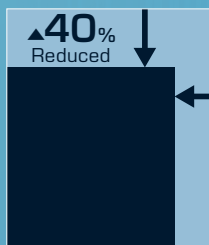

Space Saved

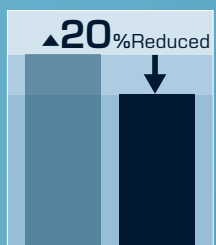

Energy Consumption

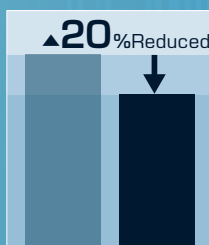

CO₂ Emissions

NBV-5-10MA/8MA

Major Specifications

Max. Pulling Force	50KN
Max. Stroke	1000mm (10MA) / 800mm (8MA)
Broaching Speed	1-15m/min
Return Speed	27m/min
Lifter Stroke	400mm
Bolster Hole Dia.	120mm
Max. Workpiece Outer Dia.	290mm
Floor Space	1,400mm×1,900mm
Machine Weight	2,000kg

Standard Accessory

- Pull Head
- Retrieving Head
- Attached tools
- Seat Plate

Special Accessory

- Auto Loader
- Chip Conveyor
- Auto Tool Changer
- Broach Stocker

Machine Layout / Dimensional Drawing

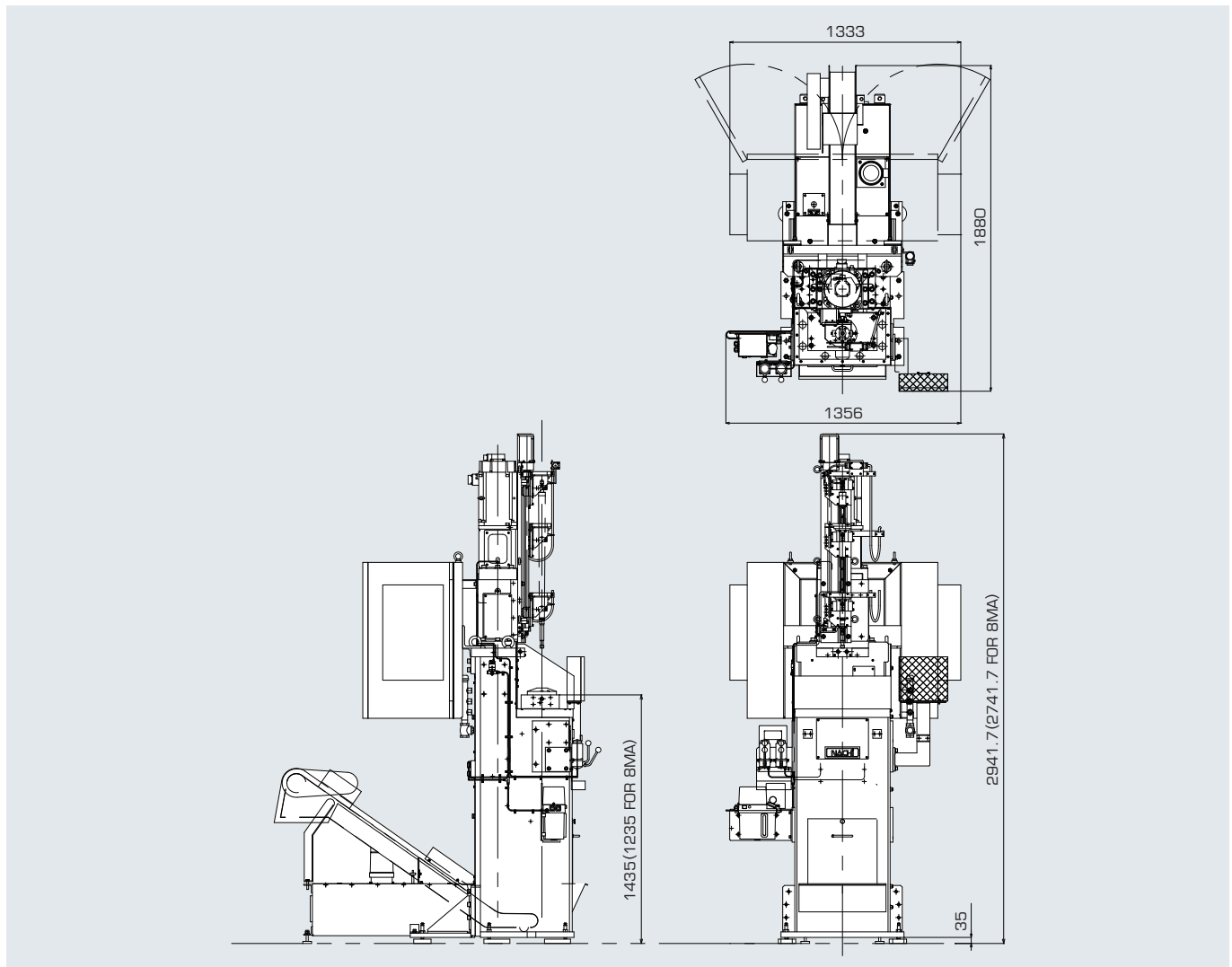

NACHI
NACHI-FUJIKOSHI CORP.

This product corresponds to COCOM list on Foreign Exchange and Foreign Trade Act
In case of export to outside of Japan, it's required the expoting permission from japanese government

<http://www.nachi.com>

Head Office
Toyama Plant

Shiodome Sumitomo Bldg. 17F, 1-9-2 Higashi-Shinbashi, Minato-ku, Tokyo 105-0021 Tel: +81-(0)3-5568-5246
1-1-1 Fujikoshi-Honmachi, Toyama 930-8511 Tel: +81-(0)76-423-5111

NACHI AMERICA INC. HEAD QUARTERS	715 Pushville Road, Greenwood, Indiana, 46143, U.S.A.	Tel: +1-317-530-1001	Fax: +1-317-530-1011	www.nachi-america.com
NACHI EUROPE GmbH	Bischofstrasse 99, 47809, Krefeld, GERMANY	Tel: +49-(0)2151-65046-0	Fax: +49-(0)2151-65046-90	www.nachi.de
NACHI SINGAPORE PTE. LTD.	No.2 Joo Koon Way, Jurong Town, Singapore 628943, SINGAPORE	Tel: +65-65587393	Fax: +65-65587371	www.nachinip.com.sg
NACHI TECHNOLOGY (THAILAND) CO., LTD. BANGKOK SALES OFFICE	Unit 23/109(A), Fl.24th Sorachai Bldg., Sukhumvit 63 Road(Ekamail), Klongtonnua, Wattana, Bangkok 10110, THAILAND	Tel: +66-2-714-0008	Fax: +66-2-714-0740	www.nachi.co.th
NACHI-FUJIKOSHI (CHINA) CO., LTD.	5F, Building A, 1988 Zhuguang Road, Quingpu District, Shanghai, 201702, CHINA	Tel: +86-(0)21-6915-2200	Fax: +86-(0)21-6915-5427	www.nachi.com.cn/

All information in this catalog is based on in-house measurements. This information is not guaranteed for all conditions.
Improvements to ratings or outer appearance may result in unannounced changes.

CATALOG NO. **M6110E**

2021.04.X-MD-ABE