

**NACHI**

INTEGRATED  
MACHINING  
CENTER  
for GEARS

SKIVING MACHINING CENTER for GEARS

**GMS200**

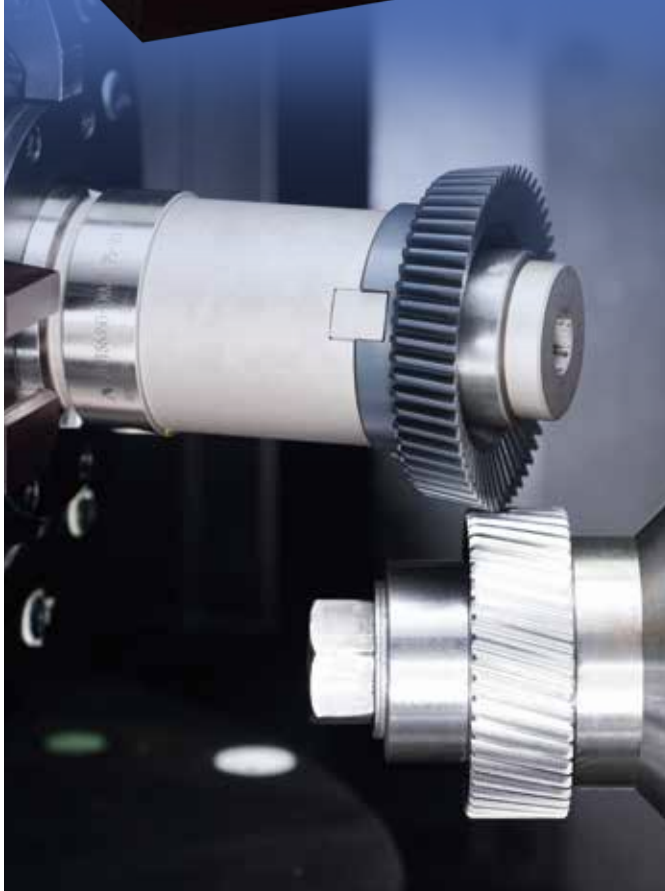

# GMS200

## General purpose • Compact Multi-function machine to include skiving function

- Best for gear machining for automotive parts
- Compact equipment with flexibility to cope with the various kinds of small quantity production and multiple processes
- Hard-skiving achieves high-precision machining of hardened gears
- Interactive operation screen provides excellent man-machine interface

**WEB VIDEO**

Please scan QR code by smart phones or mobile phones. You can watch videos of GMS200.



### Multiple process in one machine

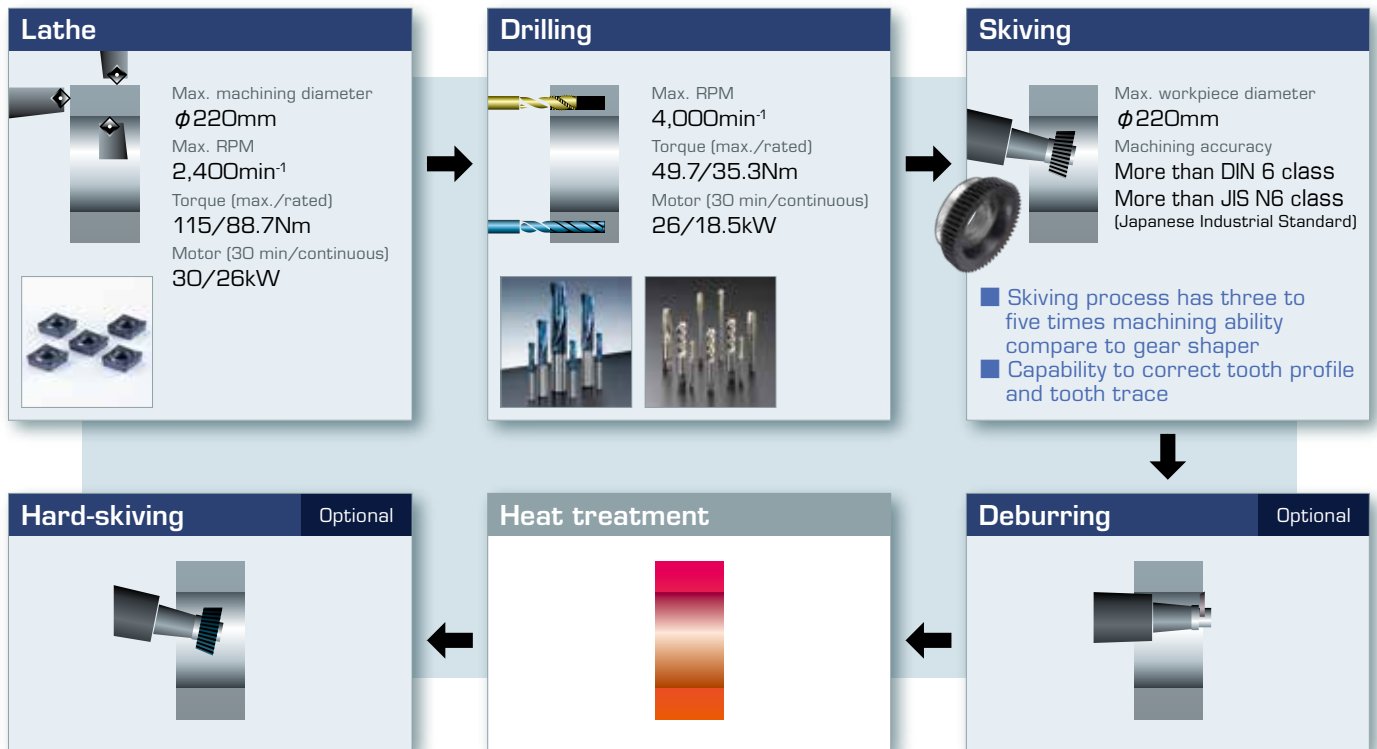

### To achieve compact production lines by reducing floor space with 3 roles in 1 machine

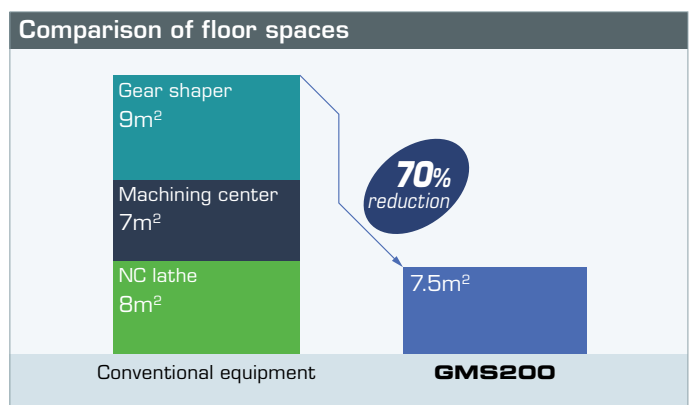

## High-efficiency gear skiving and integrated process remarkably reduce machining time

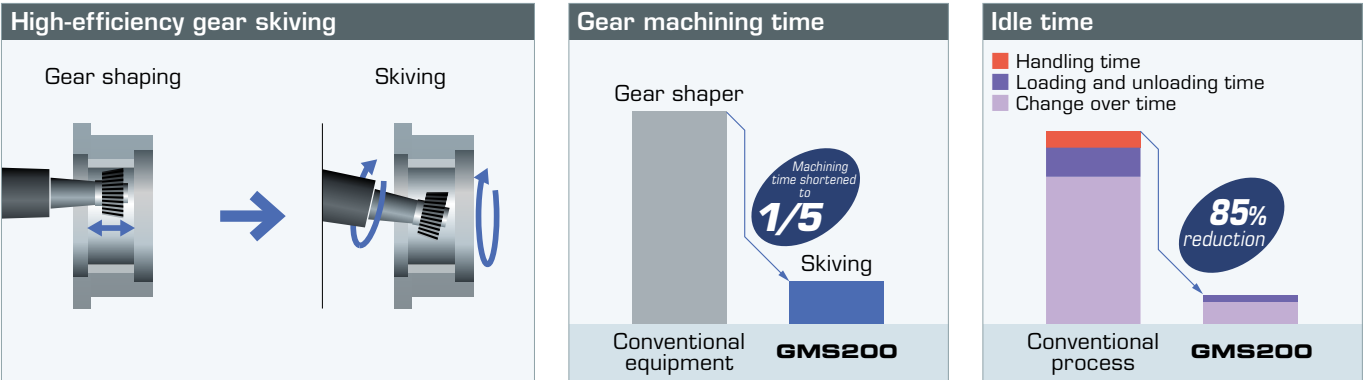

## Superior workability and operability

### Interactive operation screen for skiving (optional)

- Crowning process and run-in amount modification function (initial mode)
  - Newly added tool compensation setting and workpiece coordinate system preset
- All machining conditions for skiving can be set

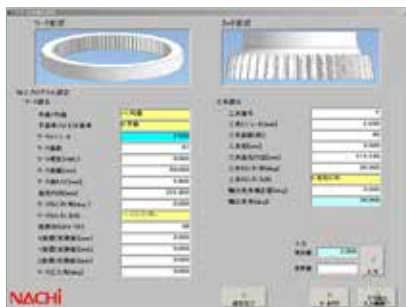

Gear specification input screen



Crowning form setting



Tool compensation setting screen

### Reduced machine height for better view

- Contribute to environment improvement in factory



### The design for auto loading system with robots

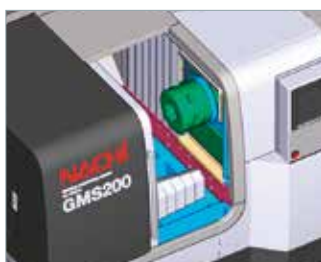
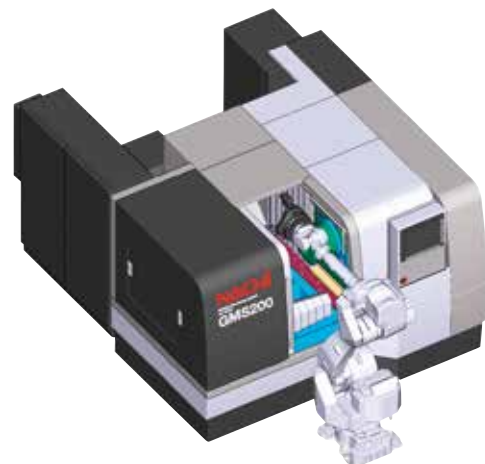

### Ceiling opening door

- Aperture dimension : 600mm
- Easy access to jig and simple loading & unloading of workpieces
- Workpiece installation height : 1,170mm

## Machining application



## Main specification

Machining capacity	Max. workpiece diameter	φ220mm
	Gear cutting tool	Skiving cutter
Cutter spindle	Spindle taper hole (tool shank type)	KM6350
	Max. RPM of spindle	4,000min <sup>-1</sup>
	Motor (30 min/continuous)	26/18.5kW
Workpiece spindle	Max. RPM of spindle	2,400min <sup>-1</sup>
	Motor (30 min/continuous)	30/26kW
Each unit traverse	Left-Right traverse (X-axis)	500mm
	Forward-Back traverse (Y-axis)	200mm
	Up-Down traverse (Z-axis)	300mm
	Tool swivel angle (B-axis)	±45deg

A.T.C.	Number of tool storage	6 piece
	Max. tool diameter	φ120mm
	Max. tool length	240mm
NC device	Tool selection method	Tool storage position fixed/random
	Type	FANUC 31i-B
Utilities	Display	FANUC 15" touch panel
	Overall power used	74kVA
Dimensions of machine	Machine height	1,680mm
	Required floor space (widthxdepth)	2,500x3,000mm
	Net machine weight	8,000kg

## Product line-up for ring gear machining

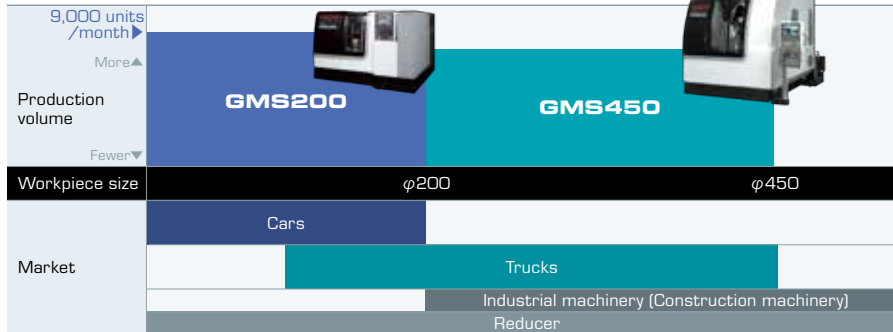

## Skiving cutter for hard-skiving



## Layout diagram

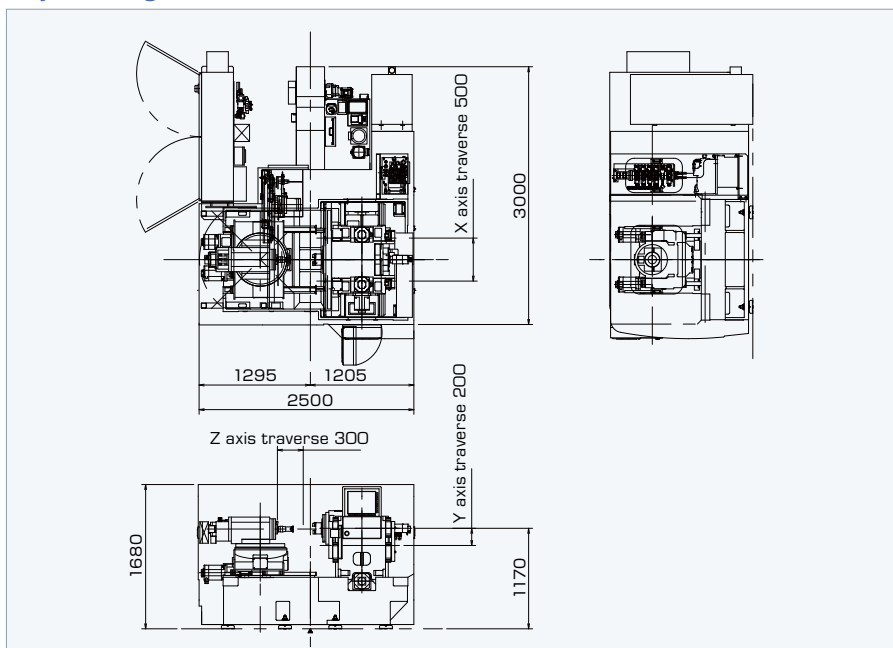

## Combine with NACHI robots for auto loading system



# NACHI

NACHI-FUJIKOSHI CORP.

<http://www.nachi.com>

Head Office  
Toyama Plant

Shiodome Sumitomo Bldg. 17F, 1-9-2 Higashi-Shinbashi, Minato-ku, Tokyo 105-0021 Tel: +81-(0)3-5568-5246  
1-1-1 Fujikoshi-Honmachi, Toyama 930-8511 Tel: +81-(0)76-423-5111

NACHI AMERICA INC. HEAD QUARTERS	715 Pushville Road, Greenwood, Indiana, 46143, U.S.A.	Tel: +1-317-530-1001	Fax: +1-317-530-1011	www.nachi-america.com
NACHI EUROPE GmbH	Bischofstrasse 99, 47809, Krefeld, GERMANY	Tel: +49-(0)2151-65046-0	Fax: +49-(0)2151-65046-90	www.nachi.de
NACHI TECHNOLOGY (THAILAND) CO., LTD.	5/5 M, 2, Rojana Industrial PARK Nongbua, Ban Khai, Rayong, 21120, THAILAND	Tel: +66-38-961-682	Fax: +66-38-961-683	www.nachi.co.th
NACHI SINGAPORE PTE. LTD.	No.2 Joo Koon Way, Jurong Town, Singapore 628943, SINGAPORE	Tel: +65-65587393	Fax: +65-65587371	www.nachinip.com.sg
NACHI (CHINA) CO., LTD.	5F, Building A, National Center for Exhibition and Convention, 1988 Zhuguang Road, Qingpu District, Shanghai, 201702, CHINA	Tel: +86-(0)21-6915-2200	Fax: +86-(0)21-6915-5427	www.nachi.com.cn

● All information in this catalog is based on in-house measurements. This information is not guaranteed for all conditions.  
● Improvements to ratings or outer appearance may result in unannounced changes.

CATALOG NO. **M6203E-2**

2018.10.X-MIZUNO